

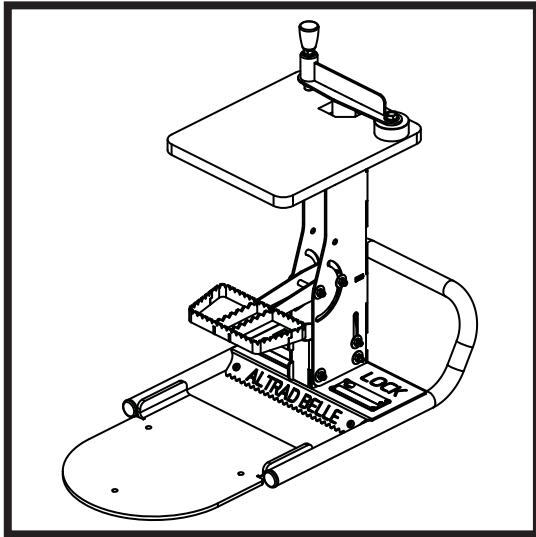

# BELLE BLOCK LOCK

870/90009/0  
11/25



Ⓜ GB Operators Manual

2



# Contents

<b><u>CONTENTS</u></b>	<b><u>PAGE NUMBER</u></b>
<b>INTRODUCTION</b> .....	<b>3</b>
WARNING .....	3
Serial Numbers.....	4
<b>PRODUCT DESCRIPTION</b>	
General.....	4
Standard Operation .....	4
Danger Zone .....	4
Main Components Locations.....	5
<b>TECHNICAL DATA</b>	
Static Dimensions.....	6
General Data .....	6
<b>SAFETY INSTRUCTIONS</b>	
General.....	8
Pre-Operation Checks.....	8
Worksites.....	8
Operating the Product .....	8
Weather Conditions.....	8
During Maintenance .....	8
After Maintenance .....	8
Modifications & Replacement Parts .....	9
Safety Decals .....	9
<b>OPERATING INSTRUCTIONS</b>	
Preparing for Use .....	10
Using the Block Lock.....	10
Storage After Use .....	10
<b>STORAGE</b> .....	<b>11</b>
<b>ENVIRONMENT</b> .....	<b>11</b>
<b>SERVICE AND MAINTENANCE</b>	
General.....	12
Maintenance Schedules.....	12
Cleaning .....	12
<b>WARRANTY</b> .....	<b>13</b>
<b>REPLACEMENT PARTS</b> .....	<b>13</b>

# Introduction



The purpose of this publication is to enable the owner/operator to maintain and use the product efficiently. If these instructions are followed carefully they will contribute to years of efficient and profitable operation of the products in the true Altrad Belle tradition.

The variations in operating conditions make it impossible for the company to make comprehensive or definite statements in its publications regarding performance and methods of use of its products, or to accept any liability for any loss or damage which may result from these statements, or from any errors or omissions.

When replacements are required, insist on genuine Altrad Belle parts, as extensive damage is liable to result from the use of inferior quality parts.

In accordance with the company's policy of continuous improvement to its products, alteration to the specifications of products may be made at any time without notice and the company accepts no responsibility for any discrepancies which may occur between the specifications of its products and the descriptions thereof contained in this publications.

This manual has been written to include all factory fitted options and specifications for world-wide use, but this does not imply that all or any of these are included in the standard product configuration. Therefore local Altrad Belle Dealer's must always be consulted about product specifications.

This manual may not in part, or in whole, be copied, photocopied, reproduced, translated, or converted to any electronic or machine readable form without written consent of Altrad Belle.

## Directives with regard to the notations.

Text in this manual to which special attention must be paid are shown in the following way:



### **CAUTION**

*The product can be at risk. The product or yourself can be damaged or injured if procedures are not carried out in the correct way.*



### **WARNING**

*The life of the operator can be at risk.*

# WARNING



### **WARNING**

*Before you operate or carry out any maintenance on this product **YOU MUST READ** and **STUDY** this manual.*

**KNOW** how to safely use the product and what you must do for safe maintenance. **ALWAYS** wear or use the proper safety items required for your personal protection. If you have **ANY QUESTIONS** about the safe use or maintenance of this unit, ASK YOUR SUPERVISOR OR CONTACT: **Altrad Belle (UK): +44 (0) 1298 84606**



## Serial Numbers

**ENSURE** you make a note of the serial numbers of your product and always quote them in any communication with Altrad Belle or one of our dealers.

### **A - PRODUCT SERIAL NUMBER**



## Product Description

### **GENERAL**

A simple yet highly effective clamping solution designed to make cutting, drilling, and grinding safer and easier on site.

This innovative system allows a wide variety of materials, including blocks, bricks, slabs, and other construction elements, to be easily and safely secured in place - all completely handsfree.

The design combines strength and stability with lightweight portability, making it effortless to move around site. Exceptionally versatile and user-friendly, the Block Lock is the smart choice for professionals reliable, go-anywhere material

### **STANDARD OPERATION**

The Block Lock is intended to be used for the following, in safe environmental conditions as described in this manual.

The clamping of materials, including blocks, bricks, slabs, and other construction elements to make cutting, drilling, and grinding safer and easier on site.

Any other use is not deemed suitable for the Block Lock. Altrad Belle will not liable for any damage or injury resulting from any use other than outlined above. The operator will be liable.

Any unauthorised modifications or attachments are prohibited. They may affect the performance and safety of the Block Lock, potentially resulting in damage to the Block Lock or injury to the operator.

Use of non-genuine replacement parts may also affect the performance and safety of the Block Loc, potentially resulting in damage to the product or injury to the operator.

### **DANGER ZONE**

The danger zone is the area around the product in which persons are endangered during standard operation as outlined above.

During operation of the product, cordon off the work area and keep members of the public and unauthorized personnel at a safe distance away from the danger zone.

## MAIN COMPONENT LOCATIONS

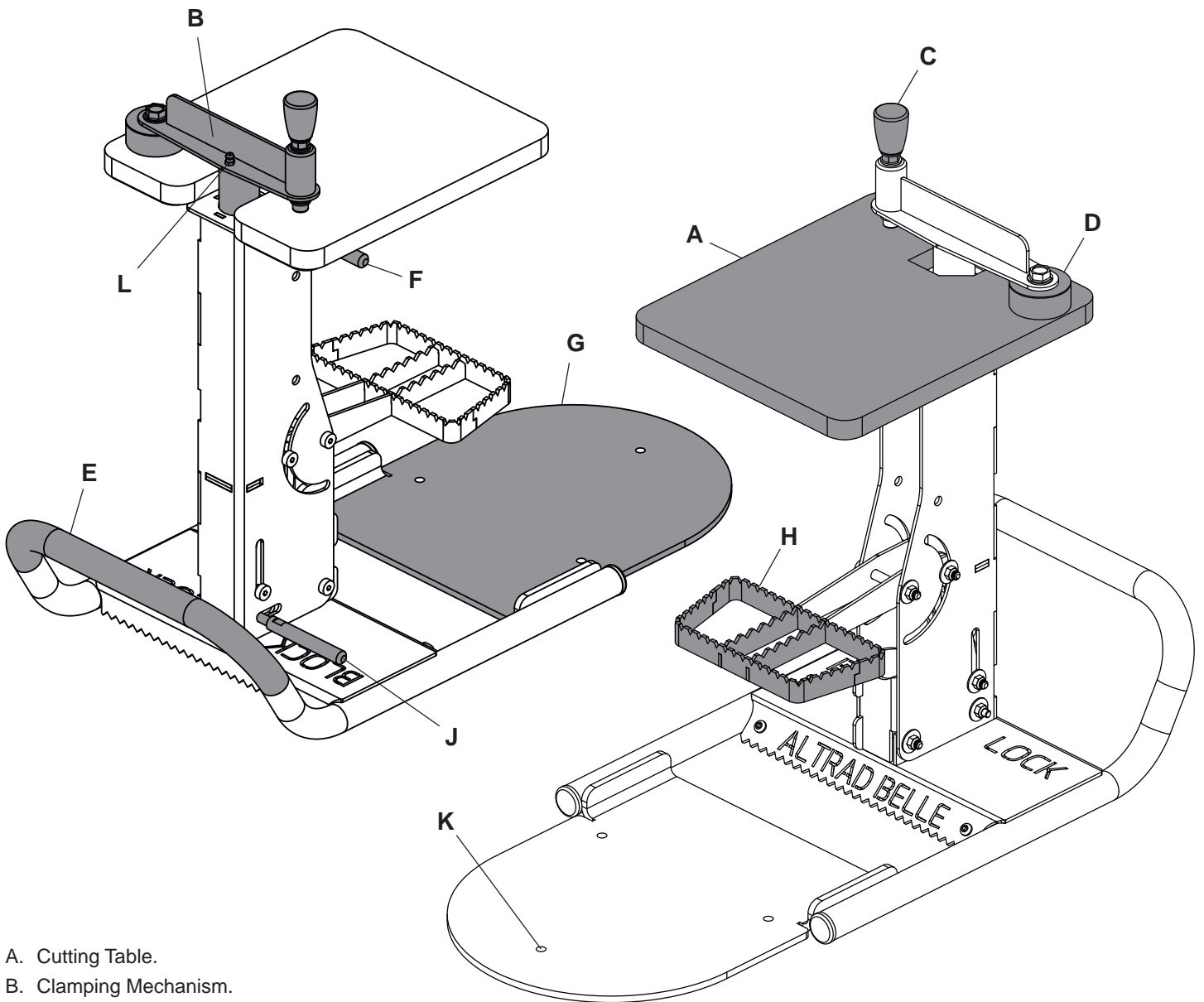

- A. Cutting Table.
- B. Clamping Mechanism.
- C. Clamping Mechanism Handle.
- D. Rubber Clamping Foot.
- E. Carry Handle (when in folded, storage position)
- F. Cutting Table Fold Lever.
- G. Foot Plate.
- H. Clamp Release Pedal.
- J. Main Body Fold Lever.
- K. Scaffold Board Securing Hole.
- L. Grease Nipple.

## STATIC DIMENSIONS

### OPERATING POSITION

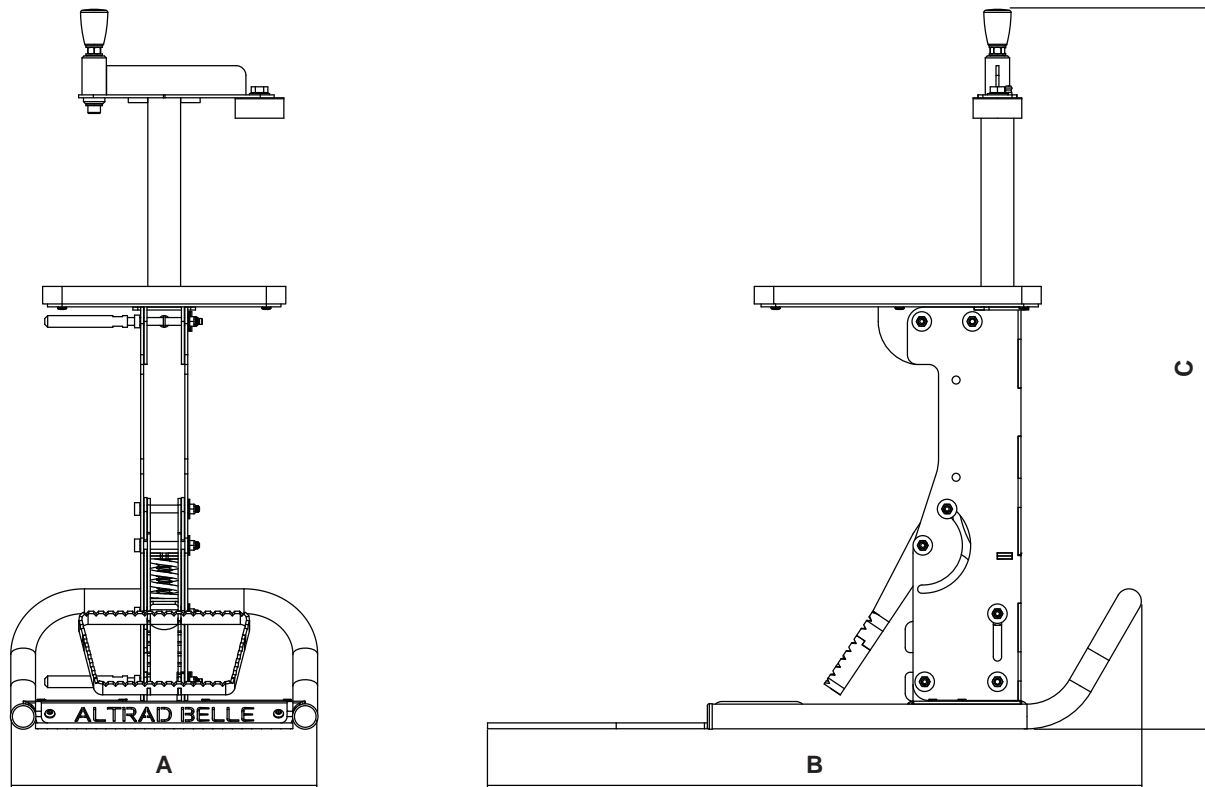

### STORAGE POSITION

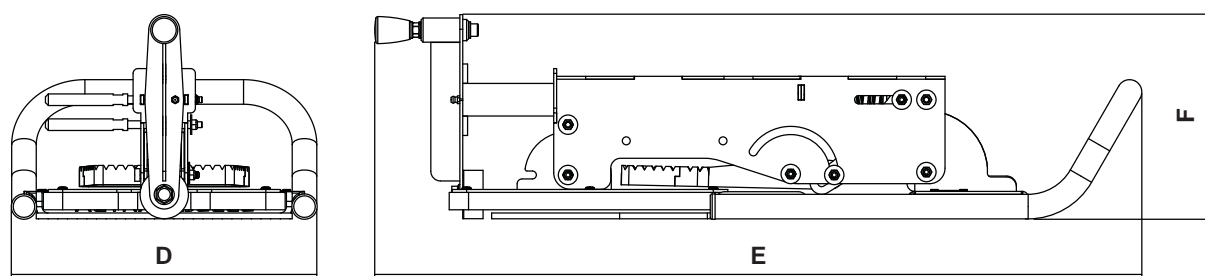

Model	Block Lock
A - Operating Width (mm)	315
B - Operating Length (mm)	690
C - Max. Operating Height (mm)	813
D - Storage Width (mm)	315
E - Storage Length (mm)	794
F - Storage Height (mm)	155

## GENERAL DATA

Model	Block Lock
Weight (Kg)	13.75
Max. Clamping Depth (mm)	245



**THIS PAGE HAS BEEN  
LEFT INTENTIONALLY BLANK**

## GENERAL SAFETY

For your own personal protection and for the safety of those around you, please read and ensure you fully understand the following safety information. It is the responsibility of the operator to ensure that he/she fully understands how to operate this equipment safely. If you are unsure about the safe and correct use of the product, consult your supervisor or Altrad Belle.



### **WARNING**

*Improper maintenance can be hazardous. Read and Understand this section before you perform any maintenance, service or repairs.*

This product is designed to eliminate the possible risks arising from the use of it. However, risks **DO** reside, and these residual risks are not clearly recognizable, and may cause personal injury or property damage, and possible death. If such unpredictable and unrecognizable risks become apparent, stop using the product immediately and the operator or his supervisor must take appropriate measures to eliminate such risks. It is sometimes necessary that the manufacturer must be informed of such event for future counter measuring.

**ALWAYS** keep the Operator's Manual and any other manuals that accompany this product to hand. Immediately replace any manuals that may have been lost or are now illegible.

## PRE-OPERATION CHECKS

The following Pre-operation inspection must be performed before using the Block Lock.

1. Thoroughly inspect the Block Lock for signs of damage. Check all components are present and secure.
2. **ENSURE** the Cutting Table is not too damaged from previous use and the material being clamped can still be clamped securely. Replace if necessary.
3. **ENSURE** all latching parts are engaging correctly
4. **ENSURE** all pivot pins are correctly located and secured.
5. **ENSURE** there is no debris or excessive dirt present on the Block Lock.
6. **DO** replace any worn/damaged warning decals.

## WORKSITES

- **ENSURE** the operator is familiar with the working surroundings. Worksites can be hazardous.
- **ALWAYS** keep the work area tidy and clear of any obstructions that may lead to accidents and/or injuries.
- Cordon off the work area and keep members of the public and unauthorized personnel at a safe distance.

## OPERATING THE PRODUCT

- **ENSURE** the operator has had adequate training prior to use and is familiar with all functions of the Block Lock
- Suitable PPE **MUST** be worn when cutting items on this equipment. Refer to the saw manufacturer's instructions for more detail.
- **ALWAYS** inform colleagues of what you will be doing and where you will be working.
- **ALWAYS** place the Block Lock on a flat, stable surface and away from any potential hazards.

## WEATHER CONDITIONS

- Rain can alter the condition of the worksite surface area. **ALWAYS** be aware of the condition of the surface after it has rained.

## DURING MAINTENANCE

- **ALWAYS** place the Block Lock on a flat, stable surface before carrying out maintenance and repair work.
- Clean the Block Lock, especially any moving components, before carrying out maintenance/repair.
- When dismantling assemblies containing components under pressure from springs, always wear suitable PPE. This will protect against eye injuries from accidental flying components.

## AFTER MAINTENANCE

- **ALWAYS** tighten any screwed connections that have been loosened during maintenance and repair.
- **ENSURE** that all consumables and replaced parts are disposed of safely and with minimum environmental impact.

## MODIFICATIONS & REPLACEMENT PARTS

- **NEVER** make any modifications or additions to the product without the prior approval of Altrad Belle. Any unapproved modifications may affect the performance and safety of the product. This may also void the Warranty.
- **ALWAYS** use genuine Altrad Belle replacement parts. Use of non-genuine replacement parts may affect the performance and safety of the product. This may also void the Warranty.

Genuine Altrad Belle replacement parts can be purchased online at [www.Altrad-Belle247.com](http://www.Altrad-Belle247.com)

## SAFETY DECALS

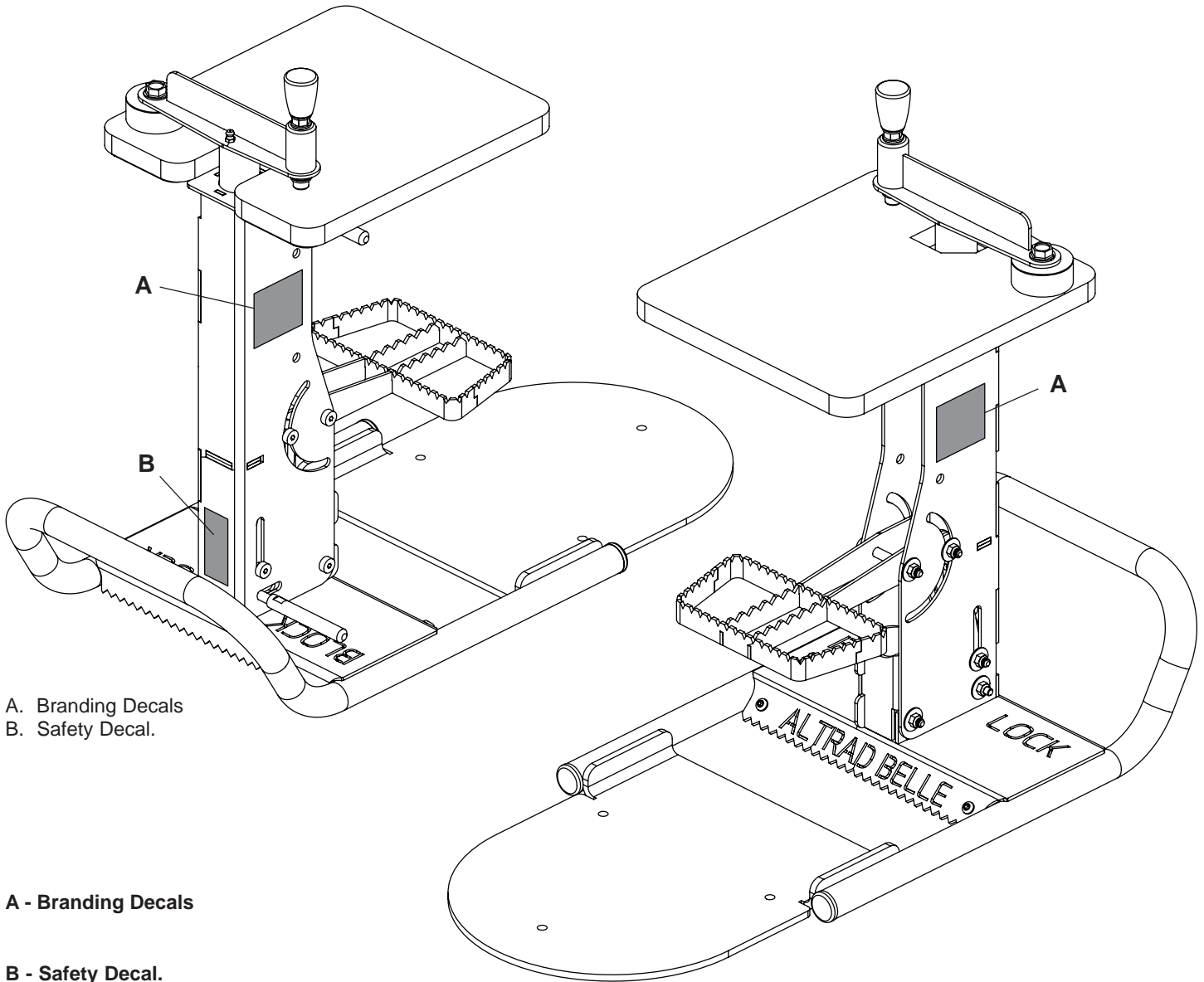

Read the  
Operators  
Manual



**WARNING!**



Hand/Finger  
Crush Hazard

## PREPARING FOR USE

1. From the storage position, place the Block Lock on a flat firm surface.
2. Pull the Main Body Fold Lever upwards to release the Main Body and fold out upwards until it locks into a fully upright position (90° to the Foot Plate).

**NOTE:-** Check that the Main Body is locked into position by attempting to move it back into the storage position.



### **CAUTION**

*ENSURE fingers are kept away from the lower section of the Main Body when folding into place to reduce the risk of trapping.*

3. Lift the Cutting Table upwards until it locks in the operating position (90° to the Main Body).

**NOTE:-** Check that the Cutting Table is locked into position by attempting to move it back into the storage position.

4. Lower the Clamp Release Pedal into place (90° to the Main Body).
5. If using the Block Lock on scaffolding, secure to the scaffolding boards using a sufficiently sized screw through the Scaffold Board Securing Holes in the Foot Plate.

The Block Lock is now ready for use.

## USING THE BLOCK LOCK

Having carried out the Pre-Operation Checks listed in the Safety Instructions section of this manual, you may use the Block Lock.

1. Select the item that requires cutting or clamping.
2. Place the item onto the cutting table.
3. Apply pressure onto the Clamp Release Pedal to lift the Clamping Mechanism.
4. Rotate the Clamping Mechanism Handle accordingly to accommodate the item being cut. Do this until the Clamping Foot touches the top of the item being cut.

**NOTE:** Rotating the Clamping Mechanism Handle clockwise will lower (tighten) the pressure of the Rubber Clamping Foot. Whilst rotating it anti-clockwise will raise (slacken) the pressure of the Rubber Clamping Foot.

5. Release the pressure on the Clamp Release Pedal. This will now sufficiently clamp the item in position ready for cutting.



### **CAUTION**

*DO NOT release the pressure on the Clamp Release Pedal until your fingers are away from the Rubber Clamping Foot.*



### **WARNING**

*NEVER attempt to cut anything until the item is fully clamped into position.*

6. Position your foot onto the Foot Plate to ensure the Block Lock is more stable during the cutting process.
7. Commence the cutting process. This can be carried out directly onto the Cutting Table or with the item being cut hanging over the edge of the Cutting Table.
8. Remove or reposition the item being cut by applying pressure to the Clamp Release Pedal as required.

**NOTE:** Whilst using the Block Lock it is advised that any debris is brushed from the Cutting Table between cuts.

## STORING AFTER USE

1. Rotate the Clamping Mechanism Handle until the mechanism is lined-up with the cut-out in the Cutting Table and the Rubber Clamping Foot is rearmost.
2. Raise the Clamp Release Pedal into the vertical/storage position, against the Main Body.
3. Push the Cutting Table Fold Lever towards the rear of the Main Body to release the Cutting Table. Lower the Cutting Table to storage position so that it lies over the Clamp Release Pedal.
4. Push the Main Body Fold Lever to the rear of the Main Body to release Main Body. Holding the Clamping Mechanism Handle lower the Main Body into the storage position until it locks into place.



### **WARNING**

*NEVER lower the Main Body by holding the Cutting Table as this may result in fingers being trapped.*

5. Ensure the Block Lock is locked into place by attempting to raise the Main Body back up into the vertical/operating position. If the Main Body moves then repeat Point 4.

If the Block Lock is not to be used for a long period of time it must be stored correctly to prevent deterioration or damage occurring during this period.

Store the Block Lock in a clean dry building with plenty of ventilation if possible. If you can only store outdoors, cover with a waterproof sheet / tarpaulin.

## PREPARING THE BLOCK LOCK FOR STORAGE

1. Clean the Block Lock and remove all unwanted material / debris.
2. Dry the product to remove any moisture.
3. Apply grease to any moving parts / grease points.
4. Examine the product for any worn / damaged parts. Replace if necessary.

## STORING THE BLOCK LOCK

1. Place the Block Lock safely on stable, level surface to reduce the risk of it accidentally falling onto someone or something.
2. **ENSURE** it is stored out of the reach of children.

## DURING STORAGE

To prevent the build up of rust and to minimise the risk of seizures, periodically carry out the Preparing for Use procedure and the Storing After Use procedure from the Operating Instructions section of this manual.

## REMOVING THE BLOCK LOCK FROM STORAGE

1. Carry out the Pre-Operation Check procedure from this manual.
2. Operate the product as per the operating instructions in this manual.

# Environment

### Safe Disposal.



Instructions for the protection of the environment.  
The product contains valuable materials.  
Take the discarded apparatus and accessories to the relevant recycling facilities.

Component	Material
Clamping Mechanism	Steel c/w BZP Finish
Clamping Mechanism Handle	Nylon
Rubber Clamping Foot	Rubber
Cutting Table	Plywood
Main Body	Steel c/w BZP Finish
Clamp Release Pedal	Steel c/w BZP Finish
Carry Handle	Steel c/w BZP Finish
Foot Plate	Steel c/w BZP Finish



## GENERAL

The Block Lock is designed to give many years of trouble free operation. It is, however, important that the simple regular maintenance listed in this section is carried out. All maintenance procedures must be carried out by a competent, suitably qualified person.

A poorly maintained Block Lock could be a danger to the operator and the other personnel on the worksite. **ENSURE** that the regular maintenance procedures listed in this manual are performed correctly and on time to keep the Block Lock safe and efficient.

**ALWAYS** use genuine Altrad Belle replacement parts, the use of spurious parts may void your warranty.

Before any maintenance is carried out on the Block Lock **ALWAYS** set it on stable, level ground.

**ENSURE** any faults identified during maintenance procedures are addressed and corrected immediately.

## MAINTENANCE SCHEDULES

### **WEEKLY**

- Clean any residue from all surfaces with a stiff brush. Water may be used but **ENSURE** all surfaces are dried afterwards.

### **MONTHLY**

- Apply two pumps of grease to the Grease Nipple.

## CLEANING

Keeping the product clean is an integral part of the service and maintenance program. The build-up of mud, dirt and debris could potentially affect the operating safety of the product, exposing both the operator and other personnel to potentially hazardous situations.

After the cleaning process check that all components are in place and secure. Replace any if necessary. Also **ENSURE** that all safety / warning decals are present in their correct locations. Replace any if necessary.

# Warranty



Your new Altrad Belle Block Lock is warranted to the original purchaser for a period of one-year (12 months) from the original date of purchase. The Altrad Belle warranty is against defects in design, materials and workmanship.

The following are not covered under the Altrad Belle warranty:

1. Damage caused by abuse, misuse, dropping or other similar damage caused by or as a result of failure to follow assembly, operation or user maintenance instructions.
2. Alterations, additions or repairs carried out by persons other than Altrad Belle or their recognised agents.
3. Transportation or shipment costs to and from Altrad Belle or their recognised agents, for repair or assessment against a warranty claim, on any product.
4. Materials and/or labour costs to renew, repair or replace components due to fair wear and tear.

The following components are not covered by warranty.

- Cutting Table

Altrad Belle and/or their recognised agents, directors, employees or insurers will not be held liable for consequential or other damages, losses or expenses in connection with or by reason of or the inability to use the product for any purpose.

## Warranty Claims

All warranty claims should firstly be directed to Altrad Belle, either by telephone, by Fax, by Email, or in writing.

### For warranty claims:

Tel: +44 (0)1298 84606

Fax: +44 (0)1298 84073

Email: [warranty.dept@altrad-belle.com](mailto:warranty.dept@altrad-belle.com)

### Write to:

Altrad Belle Warranty Department, Sheen, Nr. Buxton, Derbyshire, SK17 0EU, GB.

### Warranty Registration:

In the bid for Altrad Belle to become greener and more eco friendly, we have now introduced online Warranty registration. To access the registration page of our website, please use the following address:-

[http://www.bellegroup.com/index.php?p=warranty\\_registration](http://www.bellegroup.com/index.php?p=warranty_registration)

Alternatively, please scan the adjacent QR Code (Quick Response Code) using your smartphone to access the registration page.

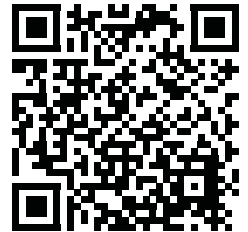

# Replacement Parts



When maintaining this product only the manufacturers original, genuine replacement parts may be used.

The user will lose any possible claims if replacement parts used are other than the makers original replacement parts.

Replacement parts for this product can be ordered online 24 hours a day, 7 days a week at [www.Altrad-Belle247.com](http://www.Altrad-Belle247.com)

For more information regarding the availability of replacement parts for this product, please contact Altrad Belle using the following contact details:-

Tel:- +44 (0)1298 84606

Fax:- +44 (0)1298 84073

Email:- [sales@altrad-belle.com](mailto:sales@altrad-belle.com)

Alternatively, please scan the adjacent QR Code (Quick Response Code) using your smartphone to access the Altrad Belle online parts portal.





BELLE  
LIGHT  
CONSTRUCTION  
EQUIPMENT

### **ALTRAD BELLE**

Sheen, Nr. Buxton, Derbyshire, SK17 0EU, GB

Tel. +44 (0)1298 84606 - Fax +44 (0)1298 84722 - Email: [sales@altrad-belle.com](mailto:sales@altrad-belle.com)

[www.Altrad-Belle.com](http://www.Altrad-Belle.com)

### **EU IMPORTER ADDRESS**

*ADRESSE DE L'IMPORTATEUR - DIRECCIÓN DEL IMPORTADOR - ENDEREÇO DO IMPORTADOR - ADRES IMPORTEUR*

*IMPORTØRENS ADRESSE - IMPORTEUR ADRESSE - INDIRIZZO DELL'IMPORTATORE - IMPORTÖRENS ADRESS - IMPORTØRADRESSE*

*MAAHANTUOJAN OSOITE - ADRES IMPORTERA - IMPORTIJA AADRESS - IMPORTĒTĀJA ADRESE - IMPORTUOTOJO ADRESAS*

*ADRESA DOVOZCE - ADRESA IMPORTATORULUI - IMPORTÓR CÍME - ADRESA UVOZNIKA - İTHALATÇI ADRESİ - ADRESA DOVOZCU*

### **ALTRAD (Group Holding)**

125, Rue du Mas Carbonnier, 34000, Montpellier, France

Tel. +33 (0) 4 67 50 53 66 - Email: [admin@altrad.com](mailto:admin@altrad.com)

[www.altrad.com](http://www.altrad.com)