



BELLE
LIGHT
CONSTRUCTION
EQUIPMENT



Altrad-Belle.com

MS 500

GB Operators Manual

4

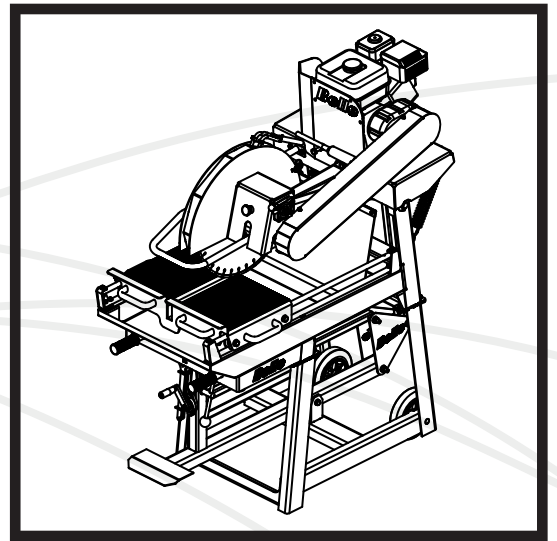

2

UKCA Declaration of Conformity

3

EC/EU Declaration of Conformity

Declaration Of Conformity (DOC)

We, **Altrad Belle, Sheen, Nr. Buxton, Derbyshire, SK17 0EU, GB** declare that the DoC is issued under our sole responsibility and belongs to the followings product(s):



PRODUCT TYPE

MODEL.....

SERIAL No.....

DATE OF MANUFACTURE

SOUND POWER LEVEL
MEASURED /
.....(GUARANTEED)

WEIGHT.....



Object of the Declaration:

Petrol engine / electric motor powered circular bench saw for cutting various types of stone & masonry.

The object of the declaration described above is in conformity with the relevant **Statutory Requirements:**

- **2008 No. 1597** Supply of Machinery (Safety) Regulations 2008
- **2001 No. 1701** Noise Emission in the Environment by Equipment for use Outdoors Regulations 2001
- **2016 No. 1091** Electromagnetic Compatibility Regulations 2016
- **2012 No. 3032** The Restriction of the Use of Certain Hazardous Substances in Electrical and Electronic Equipment Regulations 2012

The following designated standards and technical specifications have been applied:

- **EN ISO 12100:2010** Safety of machinery
- **BS EN 12418:2000+A1:2009** Masonry and stone cutting-off machines for job site. Safety
- **BS EN 61029-2-1:2012** Safety of transportable motor-operated electric tools. Particular requirements for circular saw benches
- **ISO 3744:2010** Acoustics — Determination of sound power levels and sound energy levels of noise sources using sound pressure

Technical Files are held by **Mark Pickard** at the Altrad Belle address stated above:-

Place of Declaration:-

Sheen,
Nr. Buxton,
Derbyshire,
SK17 0EU,
UK

Signed by:

Mark Pickard

Managing Director
On behalf of Altrad Belle
Sheen, Derbyshire, UK

Date of Declaration:-

April 2026



EC Declaration Of Conformity (DOC)



We, **Altrad Belle, Sheen, Nr. Buxton, Derbyshire, SK17 0EU, GB** declare that the DoC is issued under our sole responsibility and belongs to the followings product(s):



PRODUCT TYPE

MODEL.....

SERIAL No.....

DATE OF MANUFACTURE

SOUND POWER LEVEL
MEASURED /
.....(GUARANTEED)

WEIGHT.....



Signed by:

Mark Pickard
Managing Director

On behalf of Altrad Belle, Sheen, Derbyshire, UK

Place of Declaration:-
Sheen, Nr. Buxton, Derbyshire, SK17 0EU, UK
Date of Declaration:-
April 2026

Object of the Declaration:

Petrol engine / electric motor powered circular bench saw for cutting various types of stone & masonry.

The object of the declaration described above is in conformity with the relevant **Union Harmonisation Legislation:**

- **2006/42/EC** - New machinery directive
- **2000/14/EC** - Noise - equipment for use outdoors

The following harmonised standards and technical specifications have been applied:

- **EN ISO 12100:2010** Safety of machinery
- **BS EN 12418:2000+A1:2009** Masonry and stone cutting-off machines for job site. Safety
- **BS EN 61029-2-1:2012** Safety of transportable motor-operated electric tools. Particular requirements for circular saw benches
- **ISO 3744:2010** Acoustics — Determination of sound power levels and sound energy levels of noise sources using sound pressure

Technical Files are held by **Armand Ternel** at the following address:-
Altrad Investment Authority SAS: 150 Rue Le Pérugin, 34000 Montpellier, France.



EU Declaration Of Conformity (DOC)



We, **Altrad Belle, Sheen, Nr. Buxton, Derbyshire, SK17 0EU, GB** declare that the DoC is issued under our sole responsibility and belongs to the followings product(s):



PRODUCT TYPE

MODEL.....

SERIAL No.....

DATE OF MANUFACTURE

SOUND POWER LEVEL
MEASURED /
.....(GUARANTEED)

WEIGHT.....

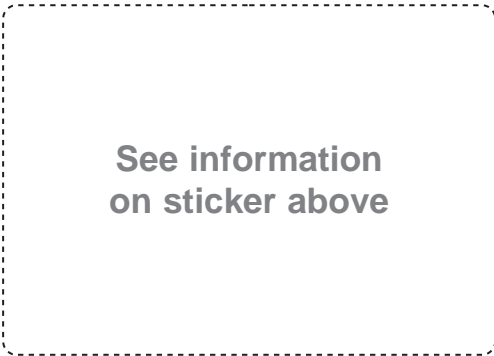

Signed by:

Mark Pickard
Managing Director

On behalf of Altrad Belle, Sheen, Derbyshire, UK

Place of Declaration:-
Sheen, Nr. Buxton, Derbyshire, SK17 0EU, UK
Date of Declaration:-
April 2026

Object of the Declaration:

Petrol engine / electric motor powered circular bench saw for cutting various types of stone & masonry.

The object of the declaration described above is in conformity with the relevant **Union Harmonisation Legislation:**

- **2014/30/EU** - EMC Directive
- **2011/65/EU** - Restriction of Hazardous Substances Directive

The following harmonised standards and technical specifications have been applied:

- **EN ISO 12100:2010** Safety of machinery
- **BS EN 12418:2000+A1:2009** Masonry and stone cutting-off machines for job site. Safety
- **BS EN 61029-2-1:2012** Safety of transportable motor-operated electric tools. Particular requirements for circular saw benches
- **ISO 3744:2010** Acoustics — Determination of sound power levels and sound energy levels of noise sources using sound pressure

Technical Files are held by **Armand Ternel** at the following address:-
Altrad Investment Authority SAS: 150 Rue Le Pérugin, 34000 Montpellier, France.



How To Use This Manual

This manual has been written to help you operate and service the Masonry Saw safely. This manual is intended for dealers and operators of the Masonry Saw.

Foreword

The '**Machine Description**' section helps you to familiarize yourself with the machine's layout and controls.

The '**Environment**' section gives instructions on how to handle the recycling of discarded apparatus in an environmentally friendly way.

The '**General Safety**' and '**Health and Safety**' sections explain how to use the machine to ensure your safety and the safety of the general public.

The '**Start and Stop Procedure**' helps you with starting and stopping the machine.

The '**Service and Maintenance**' section is to help you with the general maintenance and servicing of your machine.

The '**Trouble Shooting Guide**' helps you if you have a problem with your machine.

The '**Warranty**' section details the nature of the warranty cover and the claims procedure.

Directives with regard to the notations

Text in this manual to which special attention must be paid are shown in the following way:

 **CAUTION** *The product can be at risk. The machine or yourself can be damaged or injured if procedures are not carried out in the correct way.*

 **WARNING** *The life of the operator can be at risk.*



WARNING

 **WARNING** *Before you operate or carry out any maintenance on this machine **YOU MUST READ** and **STUDY** this manual.*

KNOW how to safely use the unit's controls and what you must do for safe maintenance. (NB Be sure that you know how to switch the machine off before you switch on, in case you get into difficulty.)

ALWAYS wear or use the proper safety items required for your personal protection. If you have **ANY QUESTIONS** about the safe use or maintenance of this unit, ASK YOUR SUPERVISOR OR CONTACT: **ALTRAD BELLE (UK): +44 (0) 1298 84606**



Contents

How to use this manual.....	4
Warning	4
Machine Description.....	5
Technical Data.....	6
Decals	6 - 7
General Safety	8
Health and Safety.....	8
Pre-Start Checks.....	9
Start and Stop Procedure.....	9
Operating Instructions	9
Service and Maintenance.....	10
Trouble Shooting Guide	11
Environment	90
Wiring Diagram - 110v.....	12
Wiing Diagram - 230v.....	13
Blade Fitment	14
Warranty	15
Replacement Parts.....	15
UKCA Declaration of Conformity.....	2
EC/EU Declaration of Conformity.....	3

Altrad Belle reserves the right to change machine specification without prior notice or obligation.

Machine Description



1. Throttle lever.
2. Choke lever.
3. Fuel ON / OFF lever.
4. Engine ON / OFF switch.
5. Air Filter Housing.
6. Fuel Tank.
7. Exhaust.
8. Recoil Starter Handle.
9. Belt Guard.
10. Foot Pedal.
11. Operating Handle.
12. Blade Height Adjustment Lever.
13. Blade Guard.
14. Cutting Table.
15. Blade Protection Plate.

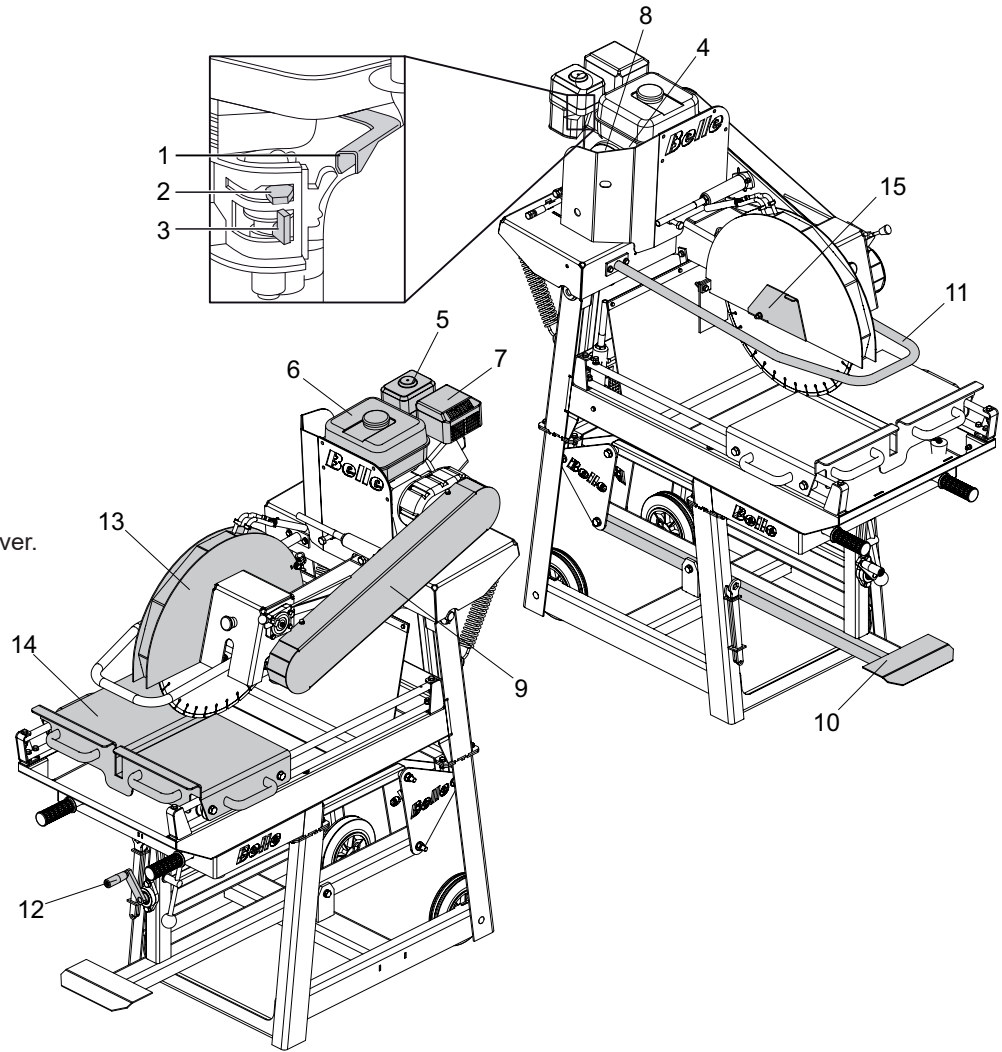

Technical Data



Model	MS500 Honda GX160 Petrol	MS500 110v / 230v Electric
Width (mm)	715	715
Height (mm)	1595	1595
Length (mm)	1410	1410
Weight (kg)	204	202.5 (110v) & 204 (230v)
Motor Power (Hp / kW)	*4.9 / 3.6	3.4 / 2.5
Motor Voltage (V)	-	110 or 230
Recommended Transformer (kVa)	-	10
Frequency (Hz)	50	50
Blade Diameter (mm)	500	500
Blade Speed (rpm)	2256	2256
Max. Cut Length (mm)	630	630
Max. Cut Depth (mm)	195	195
Water Tank Capacity (Ltr)	57.3	57.3
3 Axis Vibration (m/sec ²)	3.0	3.0
Sound Power Level (dB LWA)	107	107

* The power rating of the petrol engines indicated in this document is the net power tested on a production petrol engine for the petrol engine model and measured in accordance with SAE J1349 at a specified rpm. Mass production petrol engines may vary from this value. Actual power output for the petrol engine installed in the final machine will vary depending on numerous factors, including the operating speed of the petrol engine in application, environmental conditions, maintenance and other variables. Honda reserves the right to modify its specifications at any time and without notice.

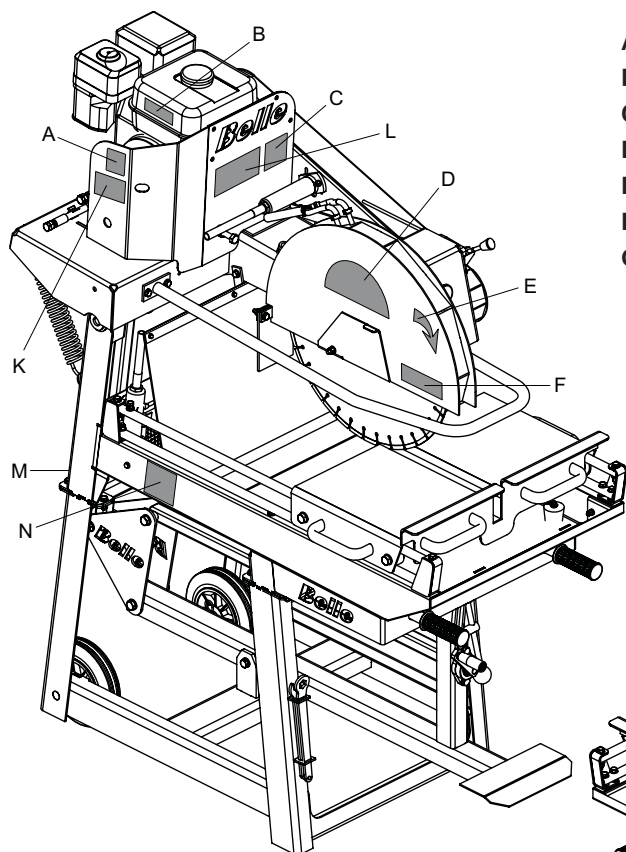

- A - Noise Decal
- B - Engine RPM Decal
- C - Operation Warning Decal
- D - Branding Decal
- E - Arrow Decal
- F - Crush Warning Decal
- G - Safety Decal

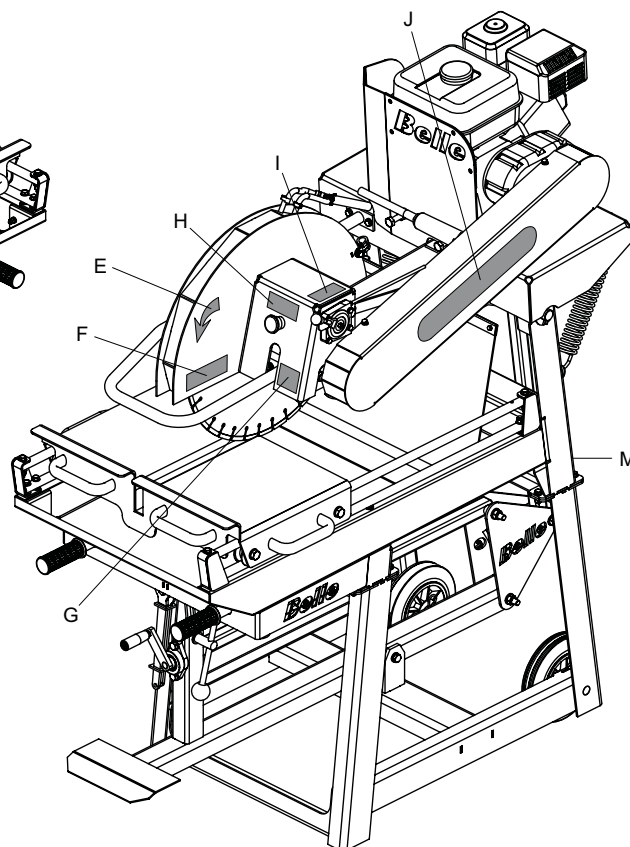

- H - Emergency Stop Decal
- I - Throttle Decal
- J - Branding Decal
- K - Air Filter Decal
- L - Transportation Decal
- M - Fork Lift Decal

A - Noise Decal

Guaranteed Sound Power Level of the machine in dB(A).

B - Engine RPM Decal

Indicates maximum speed of the engine.

C - Operation Warning Decal

Shows how to safely operate the MS500 saw.

D - Branding Decal

Identifies the model of the machine.

E - Arrow Decal

Indicates the direction in which the cutting blade is spinning.

F - Crush Warning Decal

Highlights the possible danger of 'crushing'.

G - Safety Decal

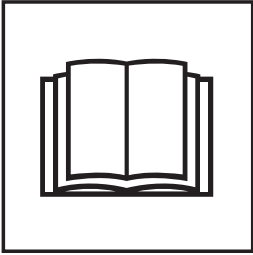

**Please Read
Operators Manual**



**Wear Protective
Footwear**

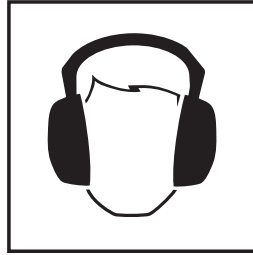

**Wear Ear
Protection**

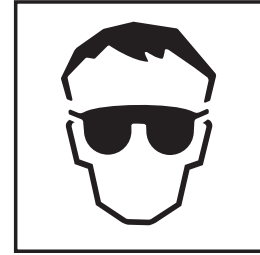

**Wear Eye
Protection**

H - Emergency Stop Decal

Indicates the position of the Emergency Stop button.

I - Throttle Decal

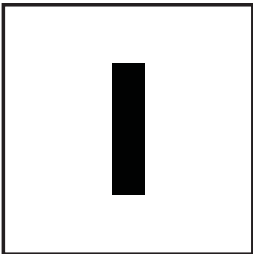

**Full Throttle
Position**

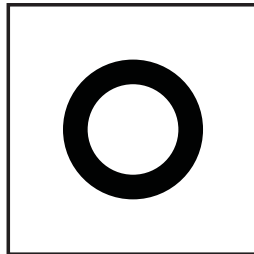

Off Position

J - Branding Decal

Indicates the company's corporate website address.

K - Air Filter Decal

Indicates the Air Filter must be cleaned on a regular basis.

L - Transportation Decal

The saw must only be moved by hand using the handle bars when situated on level ground. If the ground is uneven, a fork truck must be used (see the 'Fork Lift' decals for positioning')

M - Fork Lift Decal

This decal indicates where to place the forks of the fork truck when transporting the saw.

N - Sediment Decal

If you let sediment build up within the Water Tray to the Pump height, this may cause damage to the Pump.



General Safety

For your own personal protection and for the safety of those around you, please read and ensure you fully understand the following safety information. It is the responsibility of the operator to ensure that he/she fully understands how to operate this equipment safely. If you are unsure about the safe and correct use of the Masonry Saw, consult your supervisor or Altrad Belle.



CAUTION

Improper maintenance or use can be hazardous. Read and Understand this section before you perform any maintenance, service or repairs.

- This equipment is heavy and must not be lifted single-handedly, either **GET HELP** or use suitable lifting equipment. A special transport assembly is available for the compactor (see options).
- Cordon off the work area and keep members of the public and unauthorised personnel at a safe distance.
- Personal Protective Equipment (PPE) must be worn by the operator whenever this equipment is being used (see Health & Safety).
- Make sure you know how to safely switch this machine **OFF** before you switch it **ON** in case you get into difficulty.
- Always switch **OFF** the engine before transporting, moving it around the site or servicing it.
- During use the engine becomes very hot, allow the engine to cool before touching it. Never leave the engine running and unattended.
- Never remove or tamper with any guards fitted, they are there for your protection. Always check guards for condition and security, if any are damaged or missing, **DO NOT USE THE MASONRY SAW** until the guard has been replaced or repaired.
- Do not operate the Compactor when you are ill, feeling tired, or when under the influence of alcohol or drugs.

Fuel Safety



CAUTION

Fuel is flammable. It may cause injury and property damage. Shut down the engine, extinguish all open flames and do not smoke while filling the fuel tank. Always wipe up any spilled fuel.

- Before refuelling, switch off the engine and allow it to cool.
- When refuelling, **DO NOT** smoke or allow naked flames in the area.
- Spilt fuel must be made safe immediately, using sand. If fuel is spilt on your clothes, change them.
- Store fuel in an approved, purpose made container away from heat and ignition sources.



Health & Safety

Vibration

Some vibration from the sawing operation is transmitted through the handle to the operator's hands. The Altrad Belle Masonry Saw has been specifically designed to reduce hand/arm vibration levels. Refer to the Technical Data section for vibration levels and usage times (recommended maximum daily exposure time). **DO NOT** exceed the maximum usage times.

PPE (Personal Protective Equipment).

Suitable PPE must be worn when using this equipment i.e. Safety Goggles, Gloves, Ear Defenders, Dust Mask and Steel Toe capped footwear. Wear clothing suitable for the work you are doing. Tie back long hair and remove any jewellery which may catch in the equipment's moving parts.

Dust.

The sawing process will occasionally produce dust, which may be hazardous to your health. Always wear a mask that is suited to the type of dust being produced.

Fuel.

Do not ingest fuel or inhale fuel vapours and avoid contact with your skin. Wash fuel splashes immediately. If you get fuel in your eyes, irrigate with copious amounts of water and seek medical attention as soon as possible.

Exhaust Fumes

Do not operate the Masonry Saw indoors or in a confined space, make sure the work area is adequately ventilated.



CAUTION

The exhaust fumes produced by this equipment are highly toxic and can kill!

Plugs (Electric Only)

The MS500 Bensch Saws are intended for industrial use, the following plug types are supplied fitted to the product:

- 110V motor - 32 amp rated BS4343 plug type.
- 230V motor - 16 amp rated BS4343 plug type.

Fitting a plug - **WARNING THIS PRODUCT MUST BE EARTHED**

IMPORTANT: The wires in the mains lead are coloured in accordance with the following code:

GREEN / YELLOW = EARTH, BLUE = NEUTRAL, BROWN = LIVE

The wire which is coloured Green and Yellow must be connected to the terminal in the plug marked E or coloured Green and Yellow. The wire which is coloured Brown must be connected to the terminal in the plug marked L or coloured Red. The wire which is coloured Blue must be connected to the terminal in the plug marked N or coloured Black. Always ensure before connecting to the supply that the supply voltage is the same as the rated voltage marked on the motor

Pre-Start Checks



Pre start-up inspection

The following Pre-start-up inspection must be performed before the start of each work session or after every four hours of use, whichever is first. Please refer to the service section for detailed guidance. If any fault is discovered, the floor saw must not be used until the fault is rectified.

1. Thoroughly inspect the Masonry Saw for signs of damage. Check components are present and secure. Pay special attention to the blade safety guard.
2. Check fluid lines, hoses filler openings, drain plugs and any other areas for signs of leakage. Fix any leaks before operating.
3. Check the engine oil level and top up as necessary.
4. Check the engine fuel level and top up as necessary.
5. Check for fuel and oil leaks.

Start and Stop Procedure



Honda GX160 Petrol Engine.

1. Open the fuel tap by moving the fuel **ON/OFF** lever fully to the right.
2. If starting the engine from cold, set the choke **ON** by moving the choke lever fully to the left. If restarting a warm engine, the choke is usually not required, however, if the engine has cooled to a degree, partial choke may be required.
3. Turn the engine **ON/OFF** switch clockwise to the 'I' position.
4. Set the throttle to the idle position by moving the throttle lever fully to the right.
5. Taking a firm hold of the control handle with one hand, grasp the recoil starter handle with the other. Pull the recoil starter until engine resistance is felt, then let starter return.
6. Take care not to pull the starter's rope fully out and pull the starter handle briskly.
7. Repeat until the engine fires.
8. Once the engine fires gradually set the choke lever to the **OFF** position by moving it to the right.
9. If the engine fails to fire after several attempts, follow the troubleshooting guide.
10. To stop the engine, set the throttle to idle. Allow the engine to idle for at least 2 minutes
11. Turn the engine **ON/OFF** switch anti-clockwise to the '0' position.
12. Turn the fuel off.

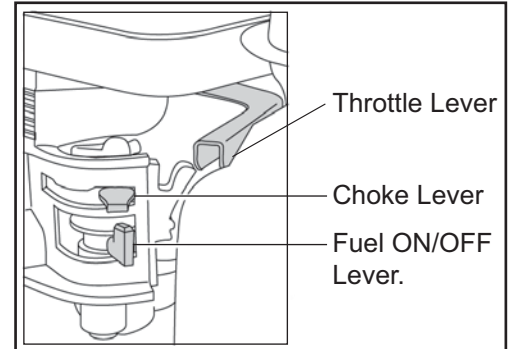

Operating Instructions



110v Motor

The 2.2kW 110v motor should use a minimum size of 10kVA continuously rated 230/110v step down transformer, connected to a suitably rated and protected power supply, in accordance with local electrical wiring regulations and standards.

230v Motor

The 2.2kW 230v motor should be connected to a suitably rated and protected power supply, in accordance with local electrical wiring regulations and standards.

Operating Instructions

- **Take the saw to where it is required.**
If the saw is to be transported to another location, ensure that the engine has been switched off. **NEVER** transport the saw with the engine still running, even if it is only being moved a short distance. The saw must only be moved by hand using the handle bars when situated on level ground. If the ground is uneven, a fork truck must be used (see the 'Fork Lift' decals for positioning')
- **Having carried out the checks listed in the 'pre start' section, you may start the engine.**
The blade should now be spinning at idle speed. **ALWAYS** check the blade for any signs of wobble, vibration or unusual noise. If any of these occur, stop the machine immediately and refer to the troubleshooting section.
- **Set the throttle to maximum and the saw is now ready for use.**
 - The speed of cutting will be determined by the type of material being cut.
 - **NEVER** plunge the blade harshly into the material being cut.
 - If the material to be cut is very hard, the saw will take longer to cut. Try to make more than one pass as this will reduce otherwise excessive wear of the blade.
 - **DO NOT** try to force the saw blade into the material as this will cause damage to the blade.
 - If the Blade stops whilst in the material being cut, stop the engine and then try to free the blade. If the engine is allowed to run whilst the blade is stationary, excessive wear will occur on the clamping plates, arbor shaft, blade and belts.
- To stop the saw - follow the start-stop procedure.
Note: There is an emergency stop button located to the right hand side of the blade guard for use in emergencies. Pressing this button will stop the engine. To reset, pull the button out.



Service and Maintenance

The Masonry Saw is designed to give many years of trouble free operation. It is, however, important that the simple regular maintenance listed in this section is carried out. It is recommended that an approved Altrad Belle dealer carries out all major maintenance and repairs. Always use genuine Altrad Belle replacement parts, the use of spurious parts may void your warranty. Before any maintenance is carried out on the machine, switch off the engine and disconnect the HT lead from the spark plug. Always set the saw on level ground to ensure any fluid levels will be correctly read. Only use recommended oils (see chart below)

Running In Period

When the Masonry Saw is first used from new, the engine oil must be changed after the initial running in period (please see engine manual for full detail). The belt tension should be checked after 4 hours use. If new belts have been fitted, they must initially be checked after 30 minutes of use.

Drive Belt

Remove the belt guard then check the belt tension by placing light finger pressure on the top of the belt, as near central between the engine drive and arbor pulley. The belt should deflect by 12mm. If the belt tension requires adjustment, loosen the four engine mounting bolts push the engine back. Then re-tighten the mounting bolts. Once set, check the belt tension a second time. Then check the pulley alignment. If the alignment is incorrect, loosen the taperlock bushes and move the pulley to suit. Once the pulley is aligned, retighten the taperlock bushes. Finally, replace the belt guard ensuring it is correctly and securely fitted.

Extension Cables

If you need to use an extension cable it must be no longer than 30 metres (100 feet) in length. The extension cable wire section should be a minimum of 6.0mm² on 110v machines and 2.5mm² on 230v machines.

Ensure that the extension cable is carefully laid out avoiding liquids, sharp edges and places where vehicles might run over it. Unroll it fully or it will overheat.

NO extension cable between the mains power source and the transformer is recommended.

Pump Alignment

The mechanical water pump is driven by the contacting the main drive belts. To adjust the pump loosen the two mounting bolts and slide the pump up or down depending on the current position. Once set, re-tighten the mounting bolts.

Routine Maintenance		Each Use	First 4 Hours	First Month / 20 Hours	3 Months / 50 Hours	6 Months / 100 Hours
Engine Oil	Check Level		✓			
	Change			✓		✓
Air Filter	Check Condition	✓				✓
	Clean				✓	
	Replace					✓
Spark Plug	Change					✓
Drive Belt	Tension		✓	✓	✓	

Oil / Fuel Type & Quantity - Spark Plug Type

	Oil Type	Quantity (Litre)	Fuel Type	Capacity (Litre)	Spark Plug Type	Electrode Gap (mm)
Petrol Honda GX160	S.A.E. 10W 30	0.6	Unleaded	3.6	BM6ES or BPR6ES	0.6 - 0.7
Reduction Box	S.A.E 15W 40	0.5	N/A	N/A	N/A	N/A

Troubleshooting Guide



Problem	Cause	Remedy
Engine will not start.	No fuel.	Open fuel tap.
		Fill fuel tank.
	Engine switched off.	Switch engine on.
	Spark plug fouled.	Clean and reset plug gap.
	Engine cold.	Close choke.
Blade not turning	Engine flooded.	Open choke, fully open throttle, pull recoil starter until engine fires.
	Belts incorrectly tensioned.	Re-tension the Belts.
Water Pump not working.	Belts broken.	Replace the Belts.
	Pump incorrectly aligned.	Re-align the Pump
	Sump blocked.	Clean the Sump.
Excessive noise, vibration or wobble from blade.	Pump worn / damaged.	Replace the Pump.
	Check condition of Arbor Shaft Bearings	Remove some of the material.
	Check tightness of Arbor Shaft Nut	Remove material and adjust.
	Check condition of Blade Flange.	Replace as necessary.
	Check Blade for signs of damage.	Replace Blade.

Environment



Safe Disposal.



Instructions for the protection of the environment. The machine contains valuable materials. Take the discarded apparatus and accessories to the relevant recycling facilities.

Component	Material
Operator Handle	Steel
Main Frame	Steel
Hand Grips	Rubber
Engine	Aluminium
Flexible Mounts	Steel & Rubber
Various Parts	Steel & Aluminium

948.3.013 110V MS500 SAW

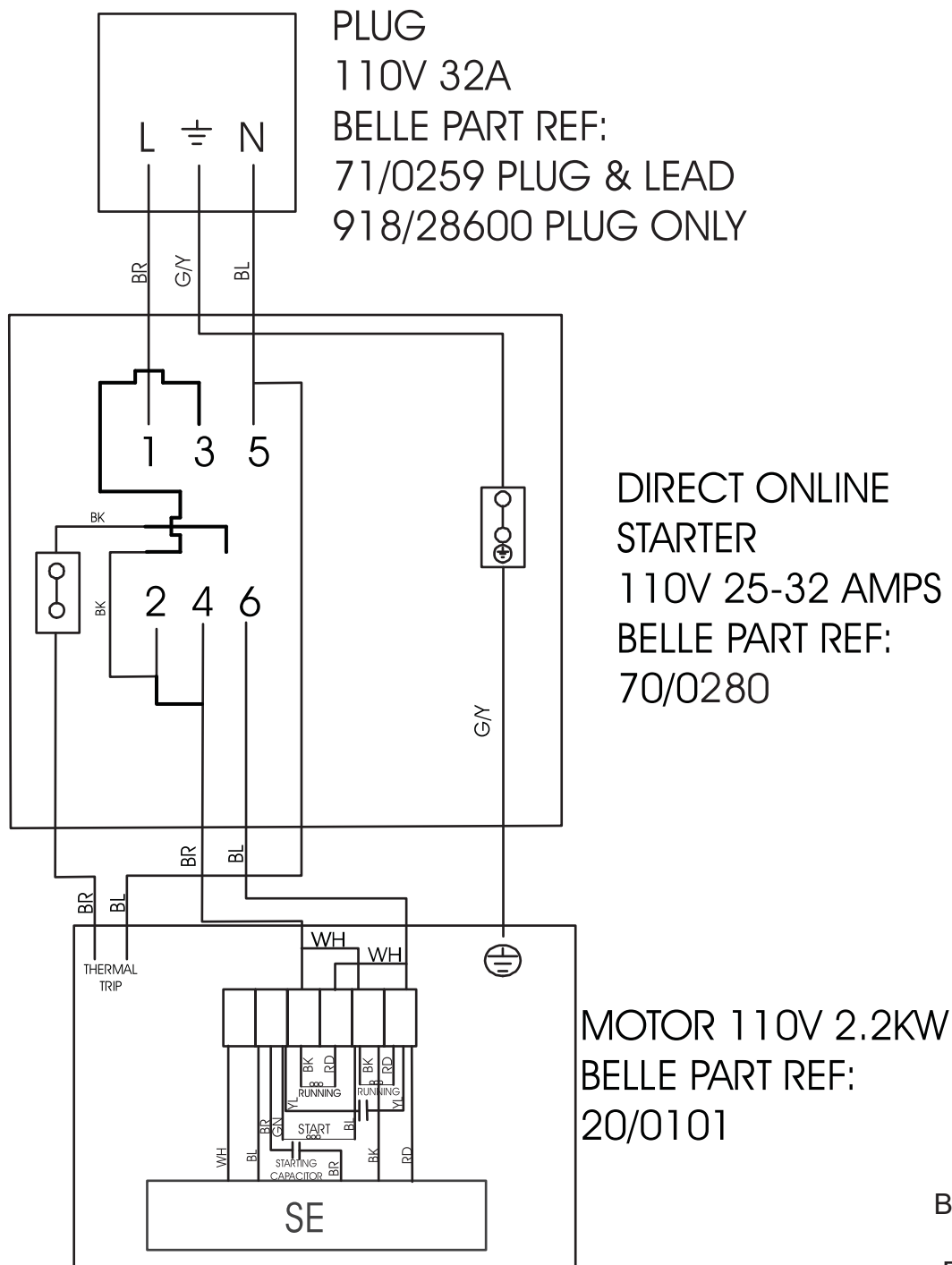

KEY

- BR = BROWN
- BL = BLUE
- BK = BLACK
- RD = RED
- WH = WHITE
- VT = VIOLET
- GR = GREEN
- YL = YELLOW
- GY = GREEN/YELLOW

948.3.019 230V MS500 SAW

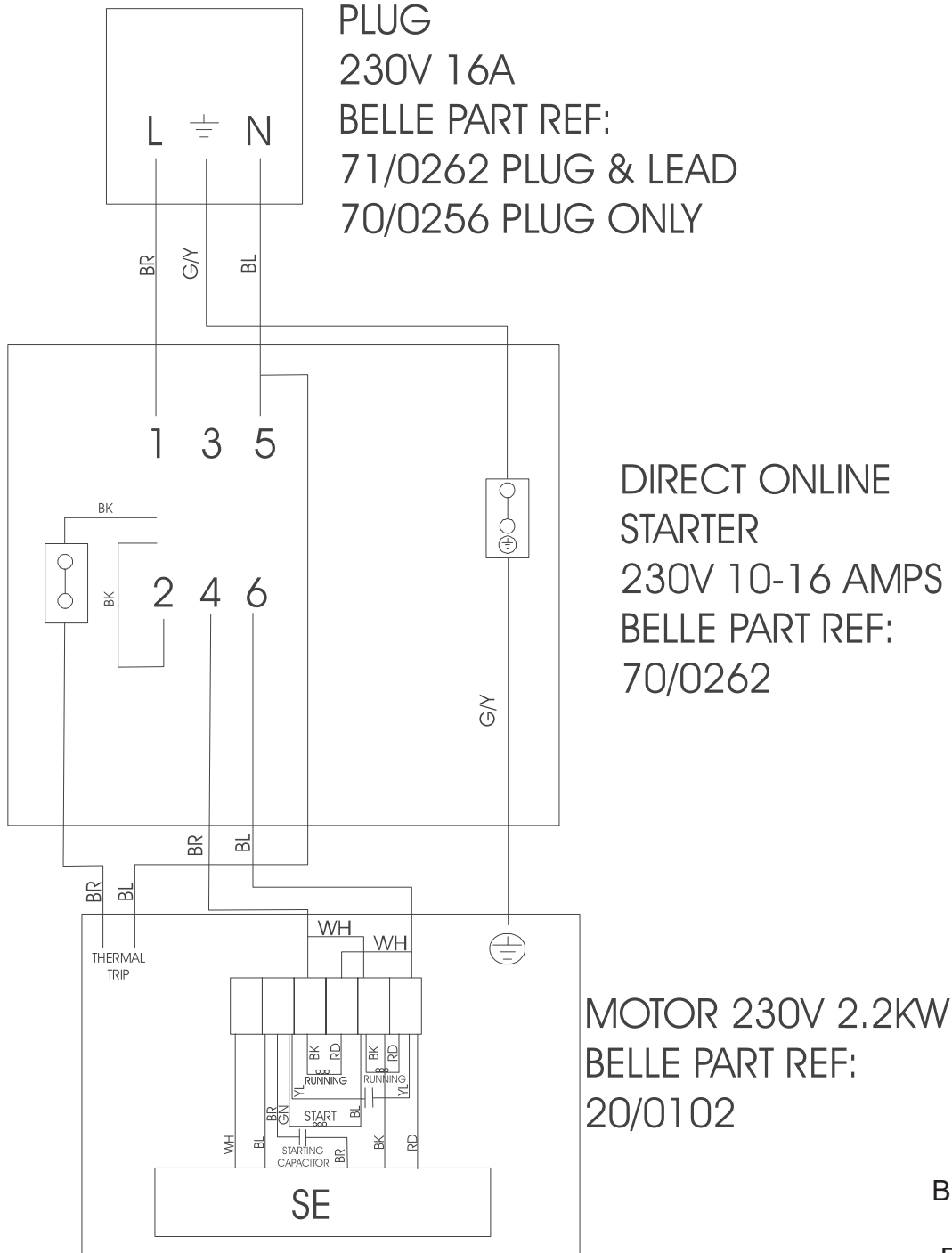

- KEY**
- BR = BROWN
 - BL = BLUE
 - BK = BLACK
 - RD = RED
 - WH = WHITE
 - VT = VIOLET
 - GR = GREEN
 - YL = YELLOW
 - GY = GREEN/YELLOW
 - YELLOW

**CAUTION**

Incorrect fitting of a blade can cause serious injury. Ensure that the fitting instructions are followed. If in any doubt, contact your supervisor or Altrad Belle.

1. Remove the HT lead from the spark plug.
 2. Expose the Arbor Shaft Bolt (9/12027) and Flange (948/05400) by raising the Blade Protection Plate **(A)** (**Figure 1 & 2**)
 3. Remove the Arbor Shaft Bolt (left-hand thread) and Outer Flange.
 4. Check the Outer Flange and Arbor Shaft (948/04700) for damage or wear. Replace if necessary, and fit the blade as laid down in the safety codes USA ANSI B7.1, Canada SCA and Great Britain HMSO No. 4.
 5. Clean the Outer Flange before mounting the blade onto the Arbor Shaft and Blade Pin (71.0.088).
 6. Ensure that the arrow on the blade points in the same direction as the rotation arrow of the blade guard.
 7. Re-fit the Outer Flange.
 8. Tighten the Arbor Shaft Bolt and secure firmly.
 9. Lower the Blade Protection Plate.
 10. Reconnect the HT lead to the spark plug.
11. The machine is now ready to be used.

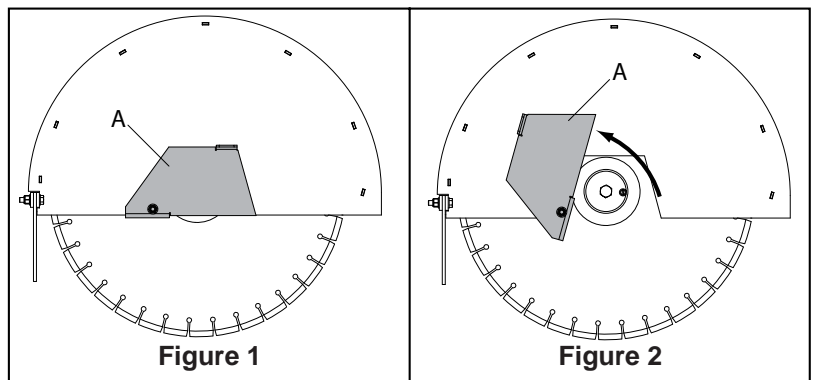
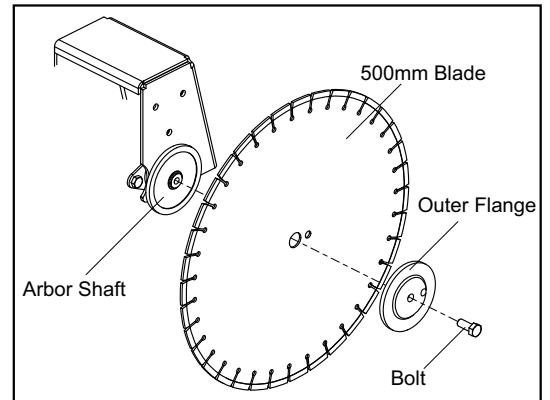

Warranty



Your new Altrad Belle Masonry Saw is warranted to the original purchaser for a period of one-year (12 months) from the original date of purchase. The Altrad Belle warranty is against defects in design, materials and workmanship.

The following are not covered under the Altrad Belle warranty:

1. Damage caused by abuse, misuse, dropping or other similar damage caused by or as a result of failure to follow assembly, operation or user maintenance instructions.
2. Alterations, additions or repairs carried out by persons other than Altrad Belle or their recognised agents.
3. Transportation or shipment costs to and from Altrad Belle or their recognised agents, for repair or assessment against a warranty claim, on any machine.
4. Materials and/or labour costs to renew, repair or replace components due to fair wear and tear.

The following components are not covered by warranty.

- Drivebelt/s
- Engine air filter
- Engine spark plug

Altrad Belle and/or their recognised agents, directors, employees or insurers will not be held liable for consequential or other damages, losses or expenses in connection with or by reason of or the inability to use the machine for any purpose.

Warranty Claims

All warranty claims should firstly be directed to Altrad Belle, either by telephone, by Fax, by Email, or in writing.

For warranty claims:

Tel : +44 (0)1298 84606,

Fax : +44 (0)1298 84073,

Email : warranty.dept@altrad-belle.com

or Write to:

Altrad Belle Warranty Department,
Sheen, Nr. Buxton
Derbyshire
SK17 0EU
England

Warranty Registration:

In the bid for ALTRAD Belle to become greener and more eco friendly, we have now introduced online Warranty registration. To access the registration page of our website, please use the following address:-

http://www.bellegroup.com/index.php?p=warranty_registration

Alternatively, please scan the adjacent QR Code (Quick Response Code) using your smartphone to access the registration page.



Replacement Parts



When maintaining this product only the manufacturers original, genuine replacement parts may be used.

The user will lose any possible claims if replacement parts used are other than the makers original replacement parts.

Replacement parts for this product can be ordered online 24 hours a day, 7 days a week at www.Altrad-Belle247.com

For more information regarding the availability of replacement parts for this product, please contact Altrad Belle using the following contact details:-

Tel:- +44 (0)1298 84606

Fax:- +44 (0)1298 84073

Email:- sales@altrad-belle.com

Alternatively, please scan the adjacent QR Code (Quick Response Code) using your smartphone to access the Altrad Belle online parts portal.

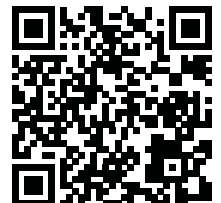



BELLE
LIGHT
CONSTRUCTION
EQUIPMENT

Altrad Belle

Sheen, Nr. Buxton, Derbyshire, SK17 0EU, GB

Tel. +44 (0)1298 84606 - Fax +44 (0)1298 84722 - Email: sales@altrad-belle.com

www.Altrad-Belle.com

EU IMPORTER ADDRESS

*ADRESSE DE L'IMPORTATEUR - DIRECCIÓN DEL IMPORTADOR - ENDEREÇO DO IMPORTADOR - ADRES IMPORTEUR
IMPORTØRENS ADRESSE - IMPORTEUR ADRESSE - INDIRIZZO DELL'IMPORTATORE - IMPORTÖRENS ADRESS - IMPORTØRADRESSE
MAAHANTUOJAN OSOITE - ADRES IMPORTERA - IMPORTIJA AADDRESS - IMPORTÉTĀJA ADRESE - IMPORTUOTOJO ADRESAS
ADRESA DOVOZCE - ADRESA IMPORTATORULUI - IMPORTÓR CÍME - ADRESA UVOZNIKA - İTHALATÇI ADRESİ - ADRESA DOVOZCU*

Altrad Investment Authority SAS:

150 Rue Le Pérugin, 34000 Montpellier, France

Tel. +33 (0) 4 67 50 53 66 - Email: admin@altrad.com

www.altrad.com